

Key

1. Envirotech clad metal edge trim.
2. Hot air welded seam.
3. Envirotech flashing piece.
4. Timber watercheck kerb.
5. Envirobond contact adhesive.
6. Enviroflex vapour control layer fully sealed to timber watercheck using Envirotech double sided butyl adhesive tape.
7. Envirotech polyurethane type FF insulation.
8. Envirotech fastener and barbed seam plate.
9. Insulation fixing.
10. Envirotech EVA 1.2mm single ply membrane by mechanical attachment.
11. Metal deck.

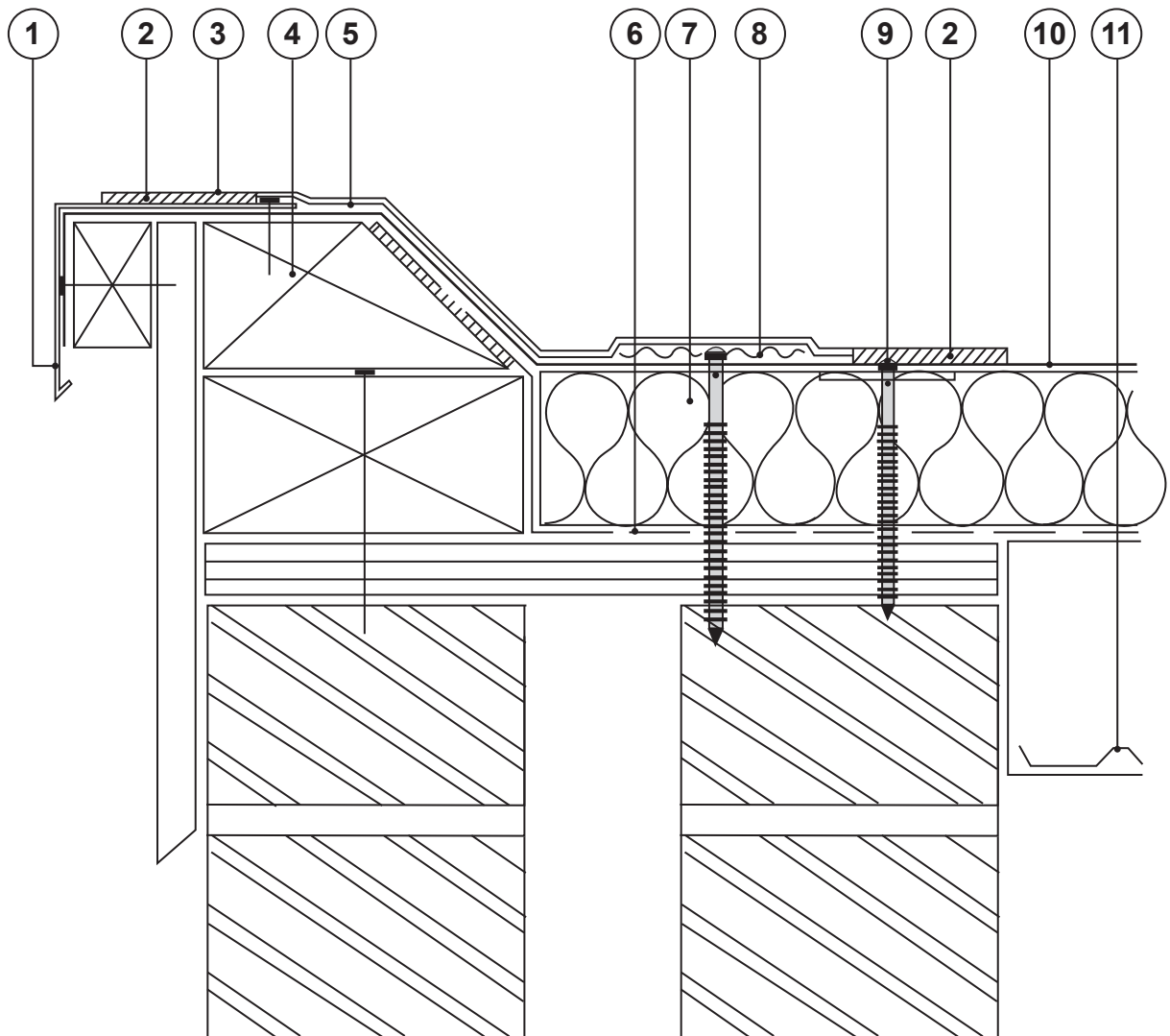

ENVIROTECH EVA

Single Ply Roofing Systems

Interloc Building Solutions Limited
 Sybrig House, Ridge Way, Dalgety Bay, Fife, KY11 9JN
 Tel: +44 (0)8700 505 925 Fax: +44 (0)8700 505 926

Email: info@interlocbuild.co.uk
www.interlocbuild.co.uk

Detail is valid only when approved by the Architect/Contractor concerned.

Title: Envirotech EVA Verge Detail With Watercheck

Drawing Ref: ENV-MF-07

Scale: Not to Scale

Revision: A

Date: January 2008

Note: this drawing is intended to illustrate the correct application of Interloc products only. All other elements are shown indicatively and are not intended to detail building construction.