

**Key**

1. External gutter fixed to fascia.
2. Envirotech clad metal to provide drip into gutter.
3. Hot air welded seam.
4. Envirotech 1.2mm buttstrap.
5. Envirotech EVA 1.2mm single ply membrane by mechanical attachment.
6. Enviroflex vapour control layer fully sealed to top of timber edge batten using double sided butyl adhesive tape.
7. Envirotech polyurethane type FF insulation.
8. Insulation fixing.
9. Metal deck.

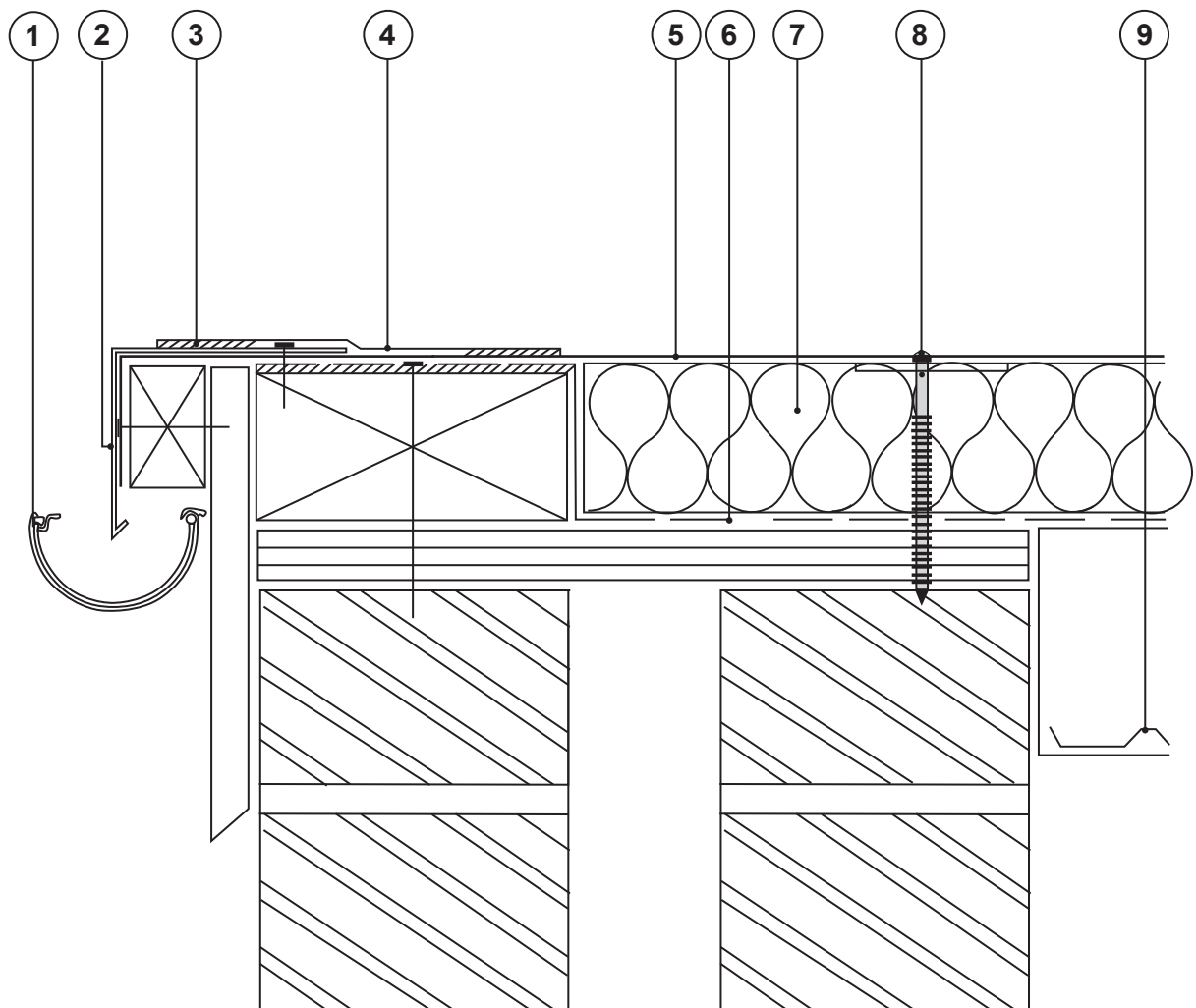

**ENVIROTECH EVA**

Single Ply Roofing Systems

Interloc Building Solutions Limited  
Sybrig House, Ridge Way, Dalgety Bay, Fife, KY11 9JN  
Tel: +44 (0)8700 505 925 Fax: +44 (0)8700 505 926

Email: [info@interlocbuild.co.uk](mailto:info@interlocbuild.co.uk)  
[www.interlocbuild.co.uk](http://www.interlocbuild.co.uk)

Detail is valid only when approved by the Architect/Contractor concerned.

Title: Envirotech EVA Eaves with External Gutter

Drawing Ref: ENV-MF-04

Scale: Not to Scale

Revision: A

Date: January 2008

Note: this drawing is intended to illustrate the correct application of Interloc products only. All other elements are shown indicatively and are not intended to detail building construction.